

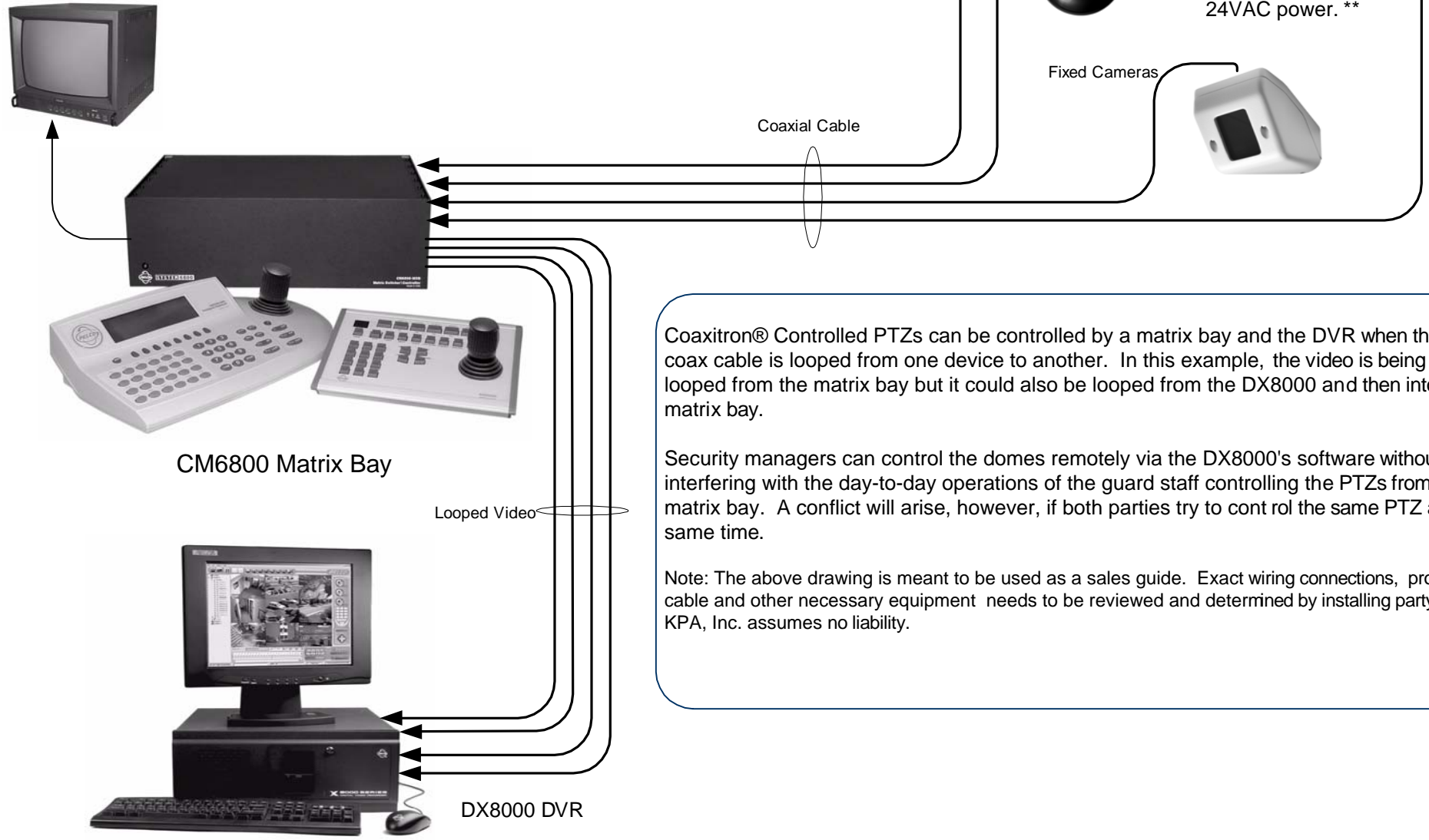

Keith Parker & Associates, Inc.
 www.cctvrep.com
 © Copyright 2004



Coaxitron® Controlled PTZs can be controlled by a matrix bay and the DVR when the coax cable is looped from one device to another. In this example, the video is being looped from the matrix bay but it could also be looped from the DX8000 and then into the matrix bay.

Security managers can control the domes remotely via the DX8000's software without interfering with the day-to-day operations of the guard staff controlling the PTZs from the matrix bay. A conflict will arise, however, if both parties try to control the same PTZ at the same time.

Note: The above drawing is meant to be used as a sales guide. Exact wiring connections, proper cable and other necessary equipment needs to be reviewed and determined by installing party. KPA, Inc. assumes no liability.